

COIN MECHANISMS

NG 2 Coin Mechanism

exploded assembly drawing

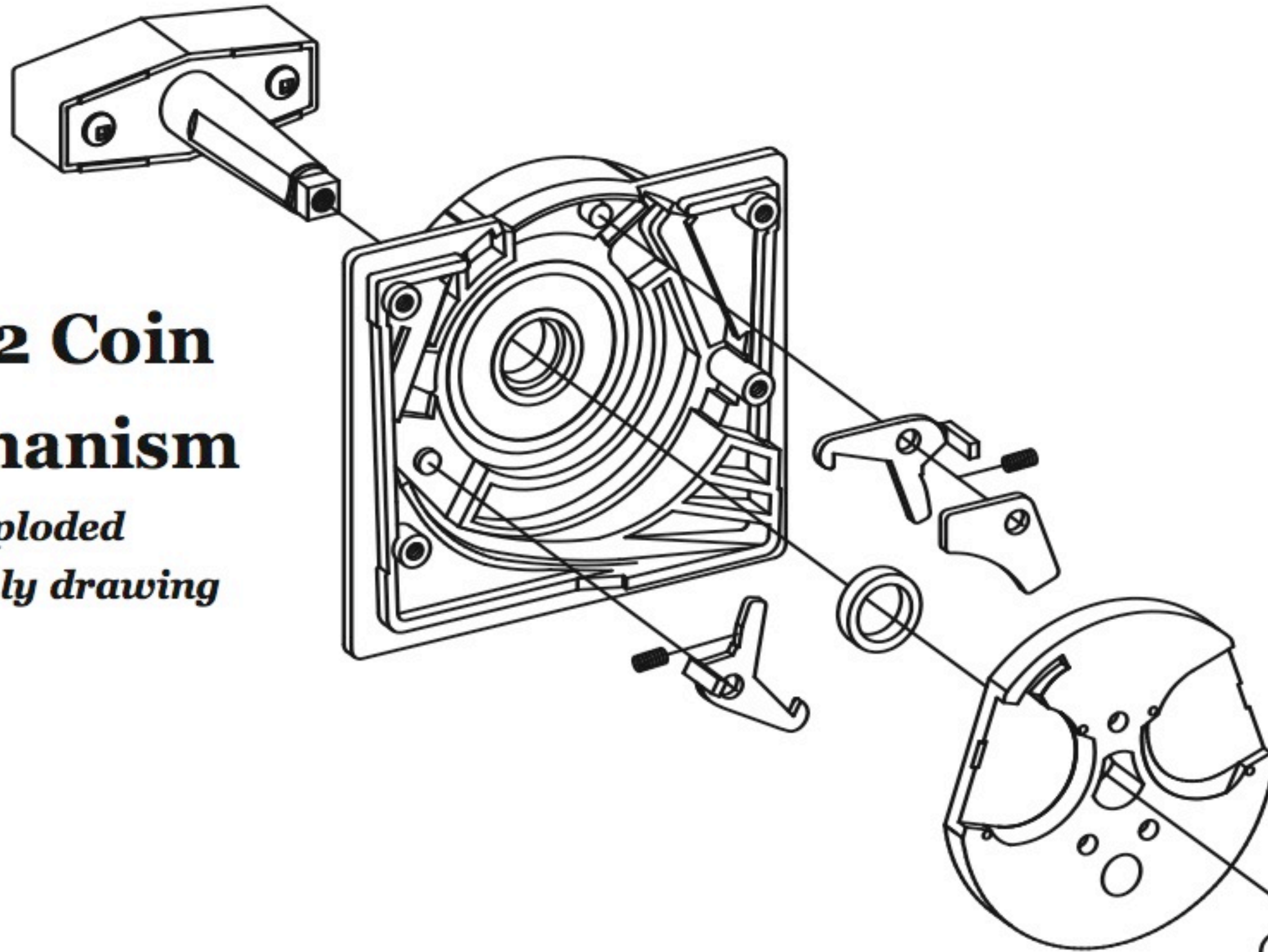

Standard Coin Mechanism

with RB Option #2

Standard Coin Mechanism

Beaver Machine Corporation's Standard Coin Mechanism is the "Classic" coin mechanism that set the industry standard many years ago. Its all metal die cast construction and triple chrome plated finish generate a level of quality only found in Beaver products. The Standard coin mechanisms are only suitable for Canada and United States currency and are designed for single coin vending to fit the Round Beaver, Southern Beaver and Ball Globe Beaver series machines, implicitly.

The Ferrous & Non-Ferrous Coin Mechanism

These mechanisms are designed to reduce the acceptance of plastic, cardboard, and metal slugs by detecting the magnetic principles of the item inserted into the coin carrier. The Ferrous coin mechanism detects plastic and cardboard slugs and the Non-Ferrous coin mechanism detects metal slugs. This technology prevents the coin mechanism from turning if a specific type slug is inserted.

Ferrous & Non-Ferrous Coin Mechanism

with RB Option #2

